

(DO NOT RE-SCALE OBJECTS)



Grid 3m from floor with 60x patch points.

8x non-dim @ dimmers.

4x 32a 6 channel (twin) Beta Pack 2 (1 channel reserved for House lights.)

DMX available at either end of space

4x 150w speakers (see plan) fed by 2 x 300w stereo amps

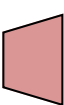
-  IWB
-  SCAFF
-  VERTICAL SCAFF
-  SPEAKER

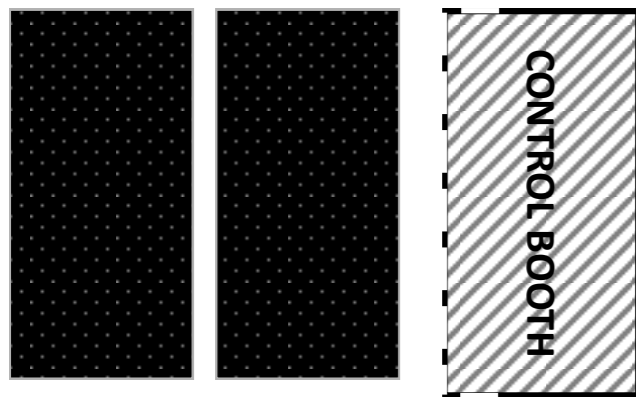

AUDIENCE ROSTRA (collapsed) and CONTROL BOOTH

Please note: These cannot be removed from Studio. The AUDIENCE ROSTRA will usually be used for END ON performances (see next page) but if not then space for it must be factored into the floor plan

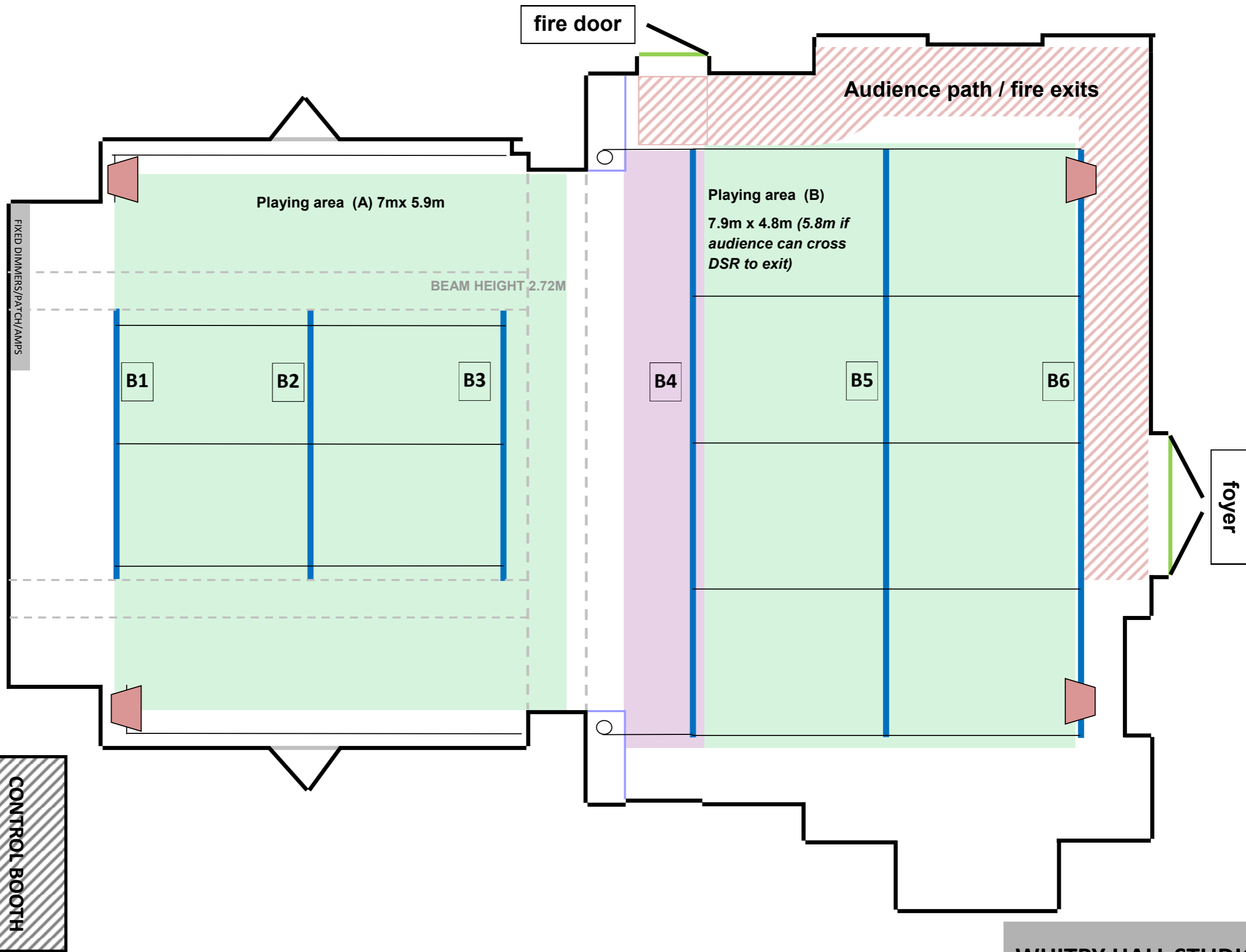

WHITBY HALL STUDIO
 1m:2cm
 PRINT A3

(DO NOT RE-SCALE OBJECTS)

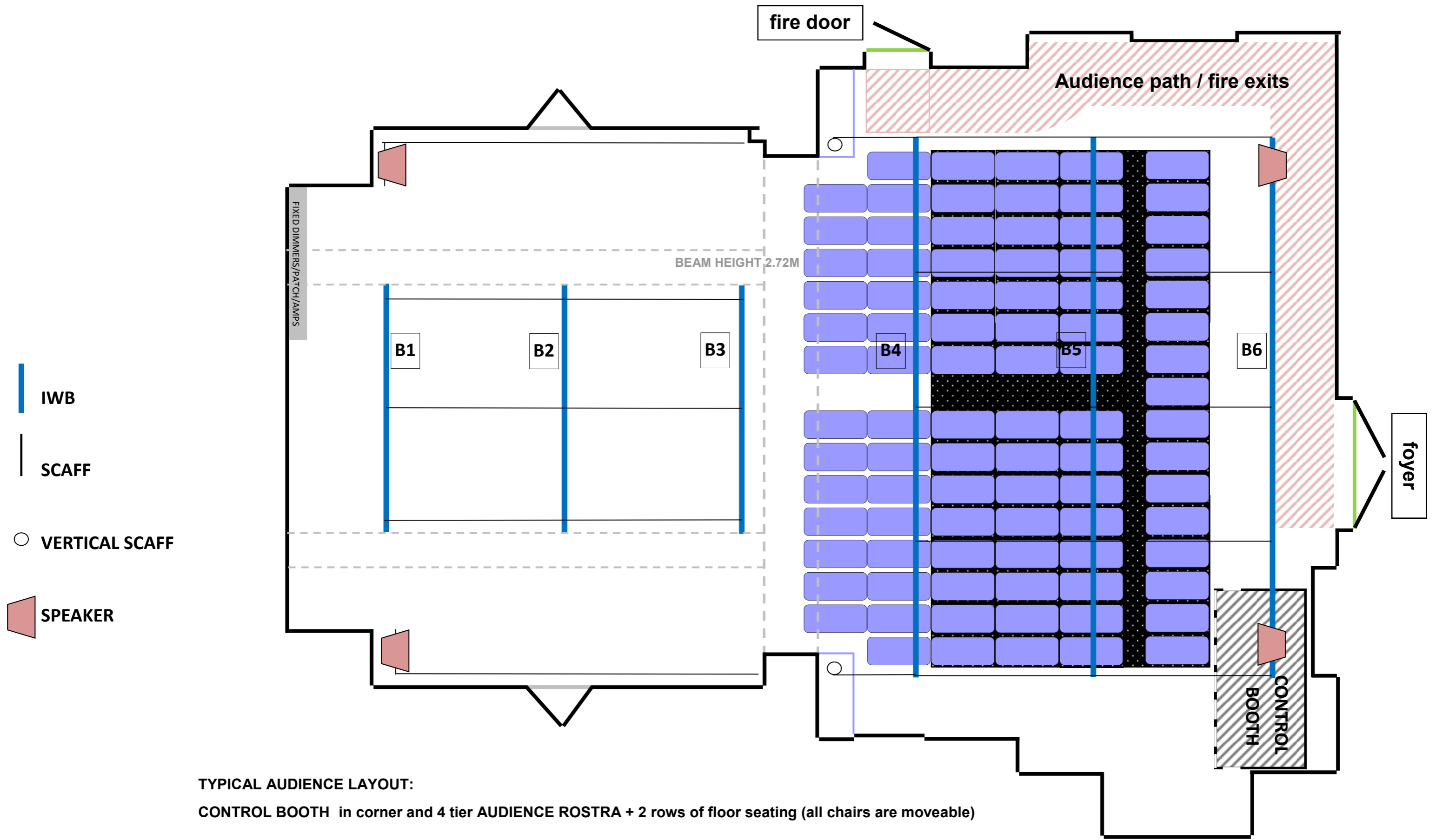

SEATS 89

WHITBY HALL STUDIO
1m:2cm
PRINT A3

(DO NOT RE-SCALE OBJECTS)

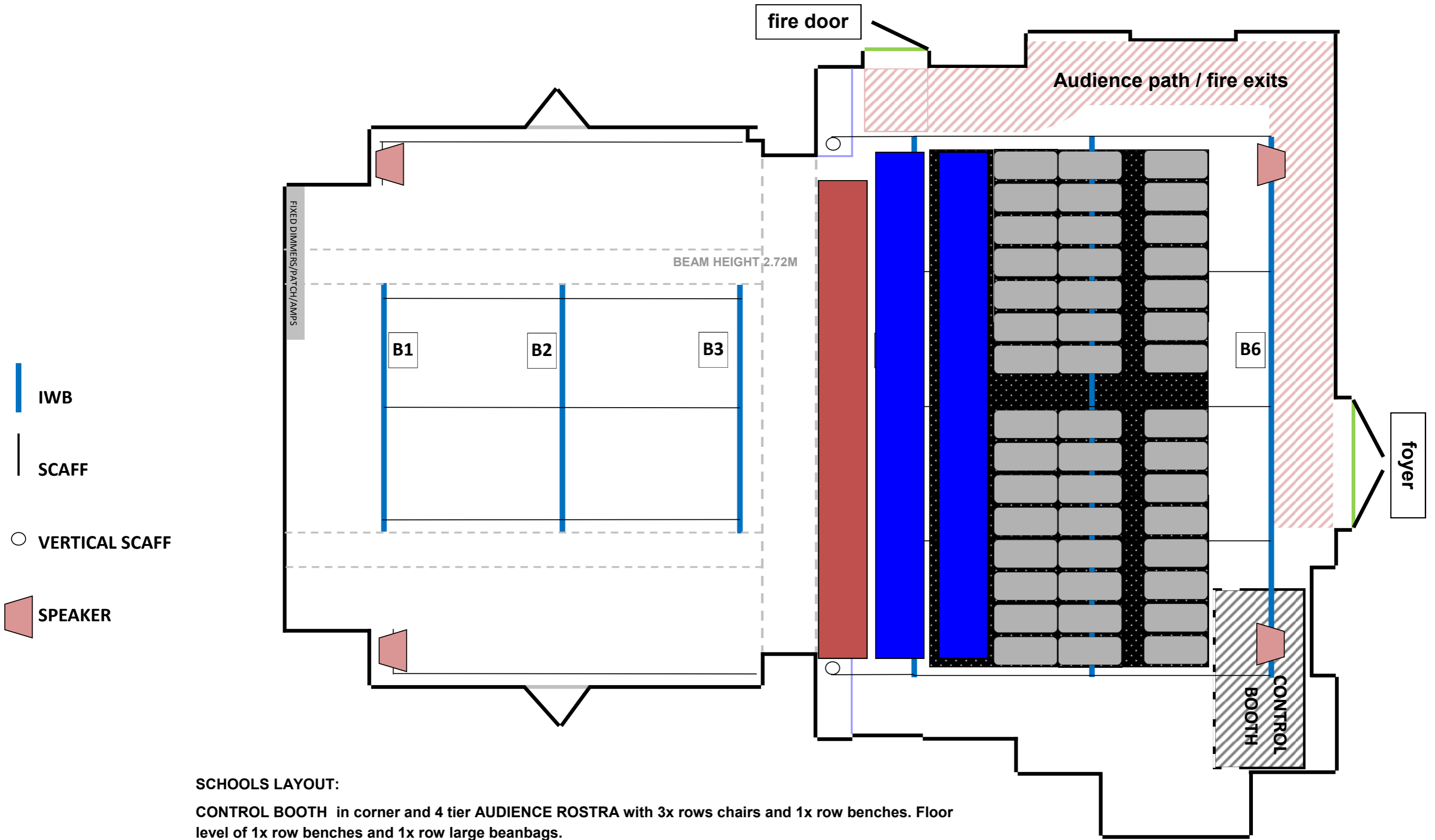

SCHOOLS LAYOUT:

CONTROL BOOTH in corner and 4 tier **AUDIENCE ROSTRA** with 3x rows chairs and 1x row benches. Floor level of 1x row benches and 1x row large beanbags.

SEATS 90-100(approx)

WHITBY HALL STUDIO
1m:2cm
PRINT A3

Action Transport Theatre, Whitby Hall Studio

[Access Plan]

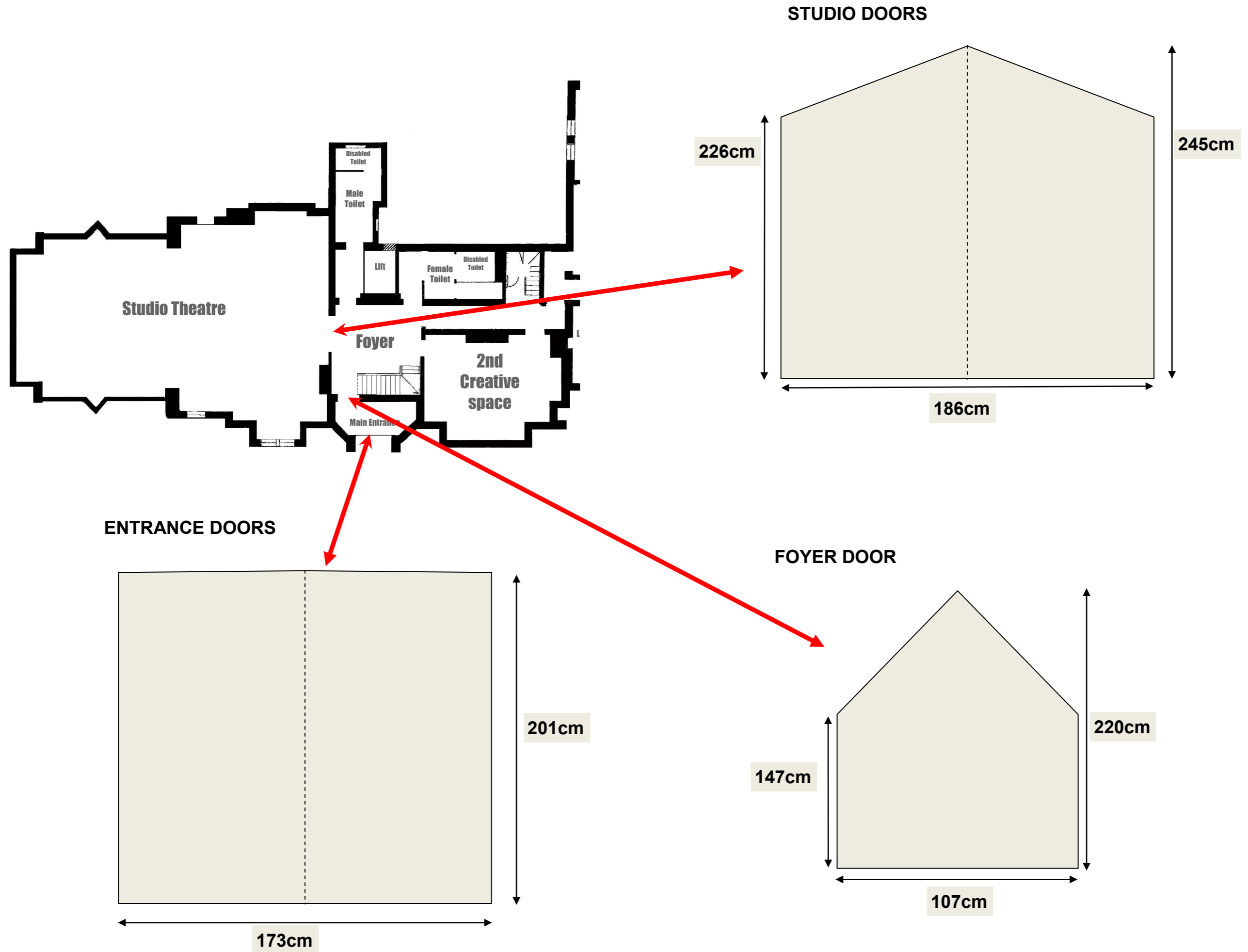

Sound devices:

Mascam CD-160 (auto cue)
Pioneer CD player
Sony MDS-E10 Minidisc recorder
Sony MDS-JE480 Minidisc player
several SM58 microphones with stands
4x DI Boxes

Desks/Amps:

Spirit Live 4(2) mixing desk (16-4-2)

Rasma WP-9110 amp

C-mark MR 2200 amp

Euro Rack UB1622-FX-pro (8-0-2)
Focusrite Scarlet t 6i6 USB Audio Interface

Speakers:

4x Rasma 150w 8ohm speaker (positioned in 4 corners of studio)

2x Laney CP10 Stage Monitor
2x Alto 800w 2way active (bluetooth usable) speakers

Connections:

Stage Line stage box (16on-4out)

Soundlab SSD30 wheeled stage box (16in -4out)

Other:

Metro Audio CMS 2 master Station – 1 headset in control booth + 1 headset/pack in back-stage area

CYC cloth

Dimmers:

4x 32a 6 channel twin BetaPack 2 (see plan)

4x 32a (on 13a adaptors) 6 channel twin analogue dimmers with DMX controller [flightcased]

Patch

60x 15a sockets dispersed throughout 6x IWBs (see plan)

8x 10a non dim (see plan)

Control

Zero 88 Fat frog

Enttec Open USB/DMX convertor

Lanterns:

12x Aclaim Fresnel (500/650w)

4x Strand 28/40 profile

15x Aclaim Axial 18/34 Profile (600w)

15x Par 64

4x Aclaim Cyc Flood with barn doors (500w)

Several Par 16 (50w)

Multiple TRS runs

For further information please contact Matt Bennett our Technical Manager

Email: technical@actiontransporttheatre.org

Tel: 0791-868-5540

*The items **underlined** are usually in the studio. If you wish to use anything else on the list please contact our Technical Manager prior to your Get-In*