



Cheshire Rural Touring Arts

Venue Tech Spec updated 2014/15

Name Of Venue Little Budworth Village Hall
Address of venue (including postcode) Vicarage Lane Little Budworth Nr Tarporley CW6 9BP
Specific local directions to venue (if its difficult to find from the address/postcode alone) Front of hall is located on Vicarage Lane postcode CW6 9BP, however access is from the rear, turn into Booth Avenue and then right into car park.
Name of contact person (s) for venue Joan Johnson
Telephone number for venue contact person (s) 01829 760422
Email for venue contact person (s) joan@johnsonlb.plus.com

Venue Information

Floor Surface and condition (eg wood, lino etc)

Floor is wood blocks, stage is high density chipboard.

Access to venue (where do the company park the van and load the set into etc)

In the car park, for unloading vehicle can access the rear double doors..

Dressing rooms / facilities (how many, what size, what facilities are included such as toilets, sinks, use of a kitchen etc)

No dressing rooms – Ladies & Gents toilets are available. The kitchen is used for the Bar and Catering

Performance area (Is there a stage and if so what size and does it have working curtains?)

We usually hire a stage for performances. Sizes available 4m x 2m or 4m x 3m. No stage curtains.

If the company are to perform on the floor, how can it be ensured all the audience can see? What may the company need to consider when preparing their seating plans?)

Hall is suitable for floor based performances, but the raised stage makes for better visibility. We always do a seating plan ourselves.

What is the venue capacity and seating available (include numbers for different set ups if you vary your layout, eg cabaret style, traditional theatre style etc, and also if you use chairs, benches mats for children etc)

Cabaret style - max 70 persons including artists. Hall does not lend itself to traditional theatre style, but this could increase capacity.

Black out. Is there a total blackout in the performance area?

Fairly good blackout.

Masking. Are there any back tabs (fabric or rigid) available to hide areas at the side of the stage? If yes please give details.

No

Power supply. Please give details of the power supply to the venue.

2 x 13amp double sockets either side of the stage.

Lighting. Please give details of any lighting available to use.

None just the hall's basic lighting.

Sound. Please give details of any sound equipment available to use.

Amplifier, microphone plus other audio inputs, 2 suspended speakers.

Is there a piano? If so please give details of type (eg upright wooden, electric etc) and is it in tune?

No!

Please add any other information you think may be helpful.

Please provide a floor plan of the venue or performance space with this form. Please include dimensions of the hall and stage area, height, width and location of doors, and locations of power sockets. Please attach the plan with this completed form.

Your cooperation is very much appreciated. Thank you.

Little Budworth Village Hall – as seen from Vicarage Lane



Little Budworth Village Hall – Interior 1 – Access & Stage end



Little Budworth Village Hall – Interior 2 Front end to Vicarage Lane



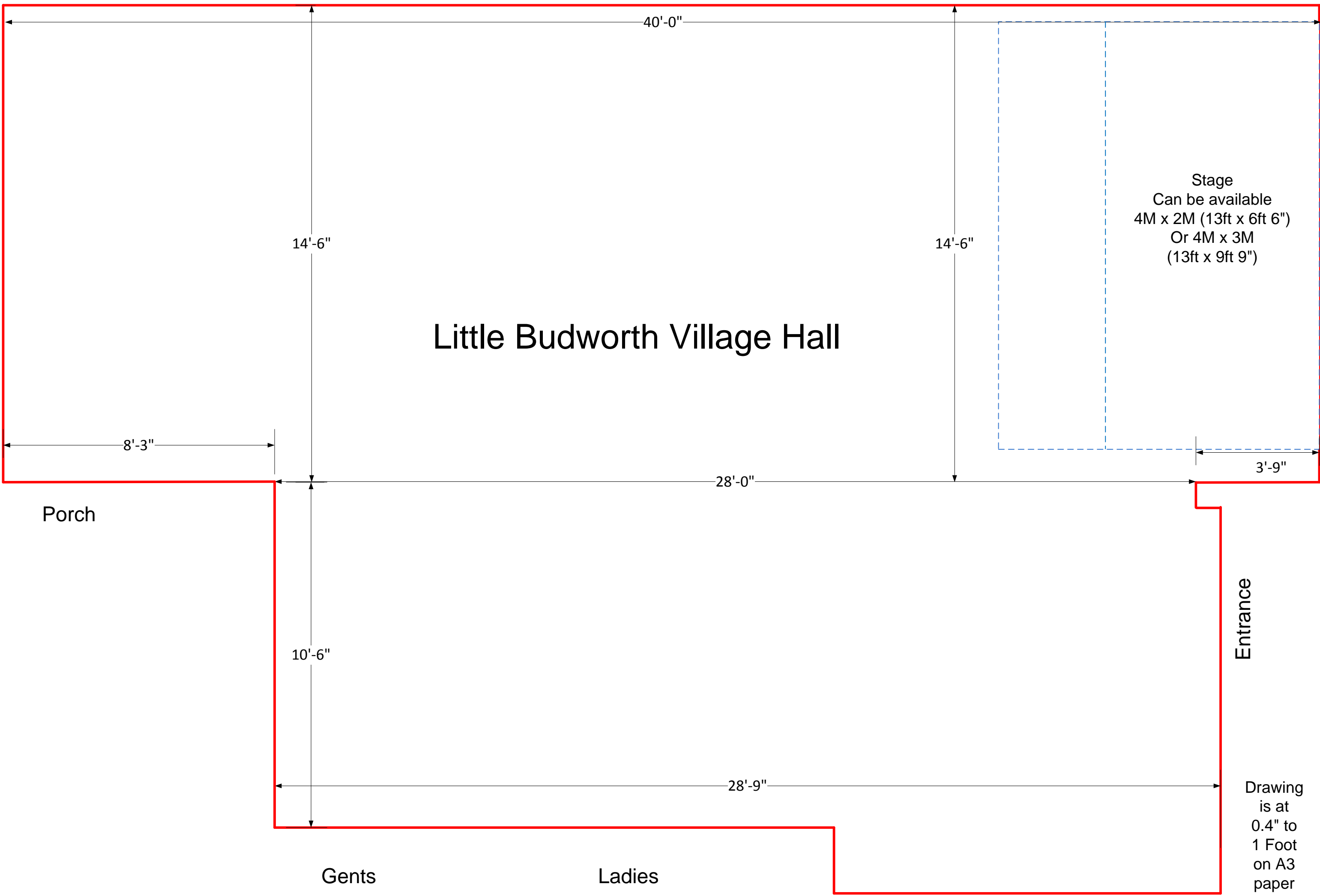

40'-0"

14'-6"

14'-6"

8'-3"

28'-0"

3'-9"

Little Budworth Village Hall

Porch

Entrance

10'-6"

28'-9"

Gents

Ladies

Kitchen

Stage
Can be available
4M x 2M (13ft x 6ft 6")
Or 4M x 3M
(13ft x 9ft 9")

Drawing
is at
0.4" to
1 Foot
on A3
paper